

RACO CLASSIC FREESTANDING SERIES

DOOR FRAME WITH SIDELIGHT

HEADER

RA413
CLIP
HR18



FREESTANDING
HINGE JAMB

DOOR STOPS SHOWN ALREADY ATTACHED TO JAMBS

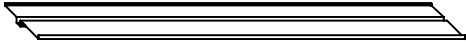

DOOR SNAP IN

RA225 / RA325
CLIP
HR 16H



FREESTANDING
STRIKE JAMB

*STRIKE PLATE
NOT INCLUDED

HR46SD
RA407

HR46D
RA408

*4-7/8"
ASA STRIKE
PREP

*2-3/4"
ASA STRIKE
PREP

RA224 / RA324
CLIP
HR16



GLAZING SNAP IN

RA406
CLIP
HR56B

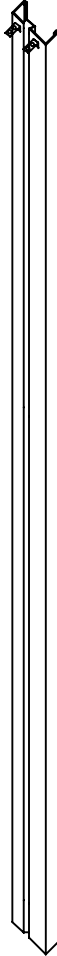

GLAZING SNAP IN

GLAZING JAMB

NARROW SNAP

RA406
CLIP
HR56B

INT. HORIZONTAL BASE

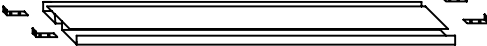

WIDE SNAP

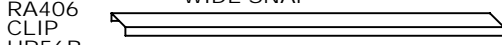

RA406
CLIP
HR56B

NARROW SNAP

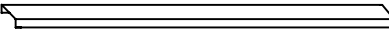

SILL BASE



WIDE SNAP

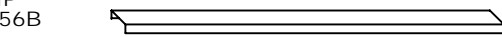

RA406
CLIP
HR56B

RA406
CLIP
HR56B

CLASSIC FREESTANDING 3-3/4" THROAT

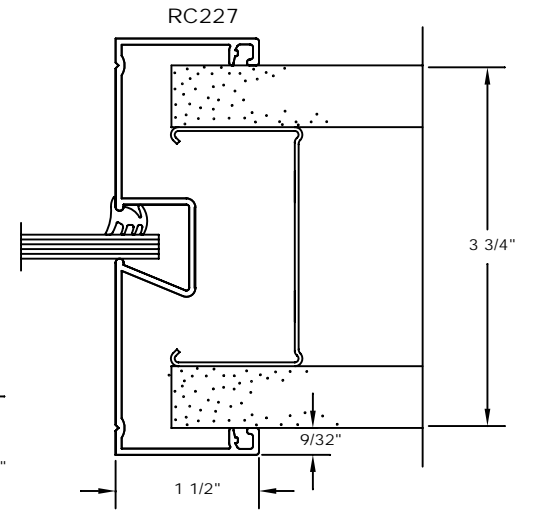
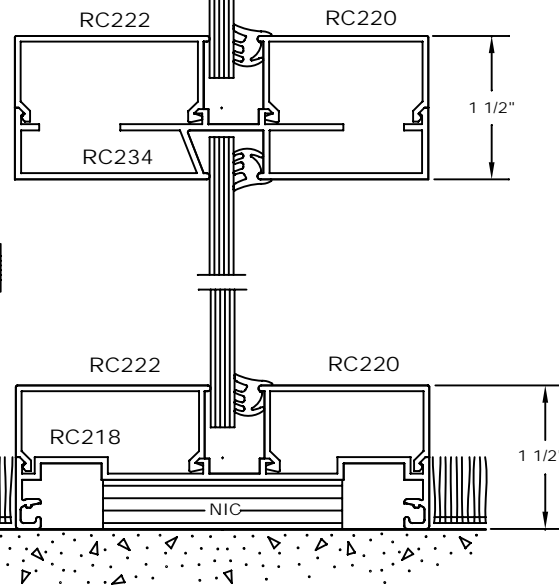
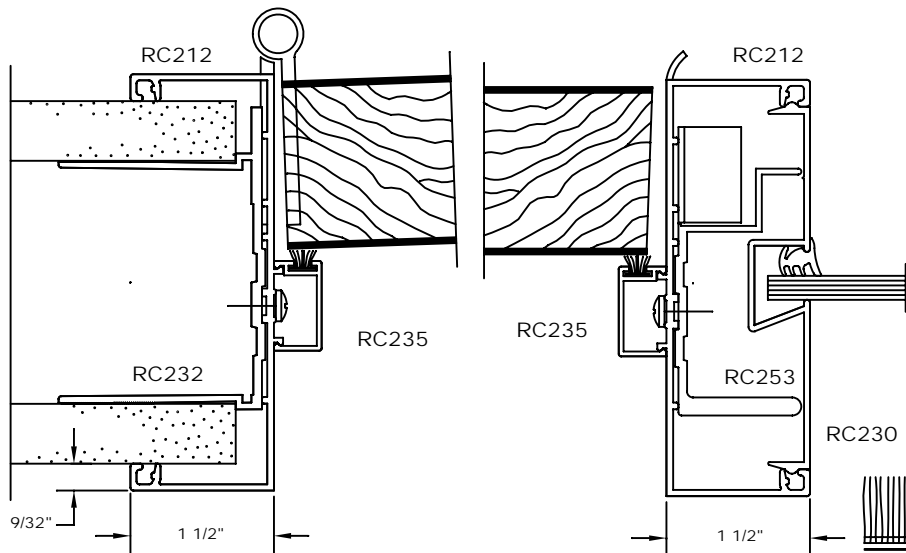
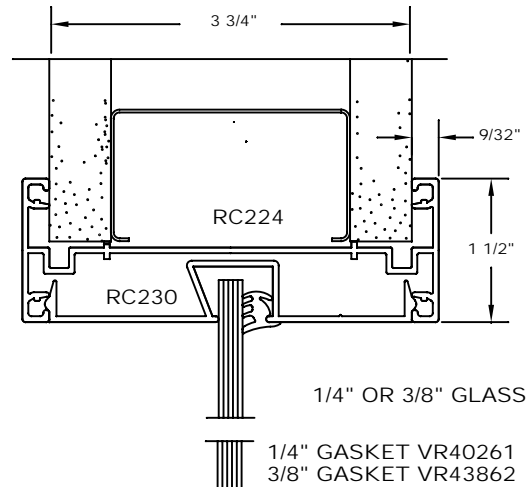
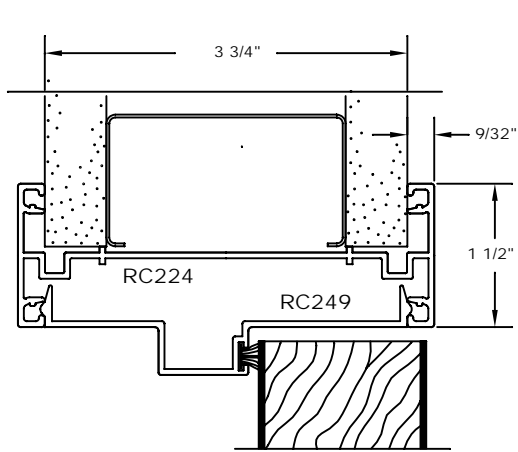

Classic

DRYWALL CONSTRUCTION

Classic is an interior door frame and glazing system designed to fit over conventional drywall construction. The system is assembled into the rough opening left in the drywall and attached to the wall. Classic fits over three common drywall throat sizes. They are 2-1/4", 3-3/4" and 4-7/8" wall thicknesses.

IMPORTANT:

WALL THICKNESS CANNOT EXCEED 1/8" THICKER THAN NOMINAL (3-3/4" OR 4-7/8").

C-STUD INSET
4" AT DOOR
FRAME JAMBS

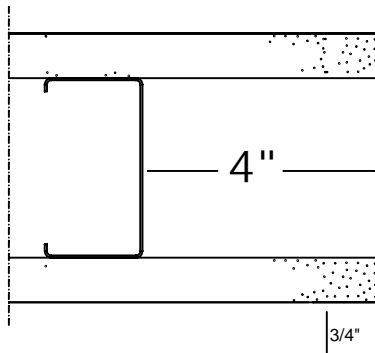

DOOR FRAME
JAMB

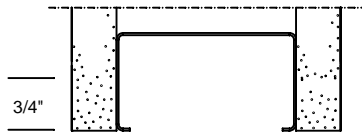

** HEAD

FRAME COVERAGE OVER WALL IS 3/4" AT HEAD AND JAMBS

FRAME COVERAGE OVER WALL IS 1/2" AT SILL



SILL

** C-STUD REVERSED
AT HEAD AND
GLAZING JAMB

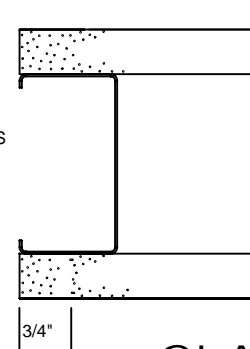

** GLAZING
JAMB

General Rough Opening Formulas

Width: 3/4" wall coverage
+ 3/4" wall coverage
+ door opening width
+ intermediate vertical(s) if any
+ daylight opening width(s) if any

Height: 3/4" wall coverage
+ door opening height

Borrowed light or Clerestory Height
3/4" wall coverage at head
+ intermediate horizontal(s) if any
+ daylight opening height(s)
+ 1/2" wall coverage at sill

GENERAL INSTALLATION INSTRUCTIONS

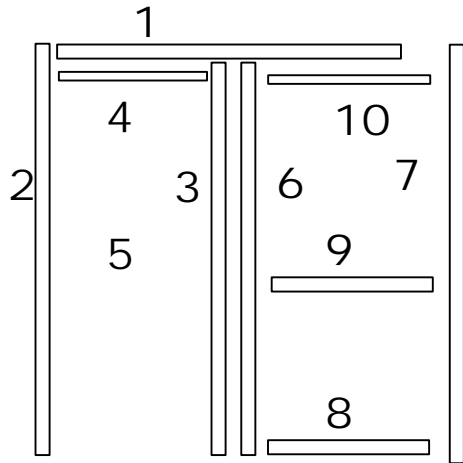

1. PLACE HEAD OVER DRYWALL
2. PLACE HINGE JAMB OVER DRYWALL AND ATTACH TO HEAD. LEVEL HEAD AND PLUMB HINGE JAMB. ATTACH TO WALL
3. ATTACH STRIKE JAMB TO HEAD. PLUMB JAMB AND ATTACH TO FLOOR
4. SNAP IN DOOR FRAME HEAD INSERT.
5. ATTACH DOOR STOPS TO JAMBS.
6. SNAP IN GLAZING INSERT INTO STRIKE JAMB
7. PLACE GLAZING JAMB OVER DRYWALL AND ATTACH TO HEAD
8. ATTACH SILL TO STRIKE JAMB AND GLAZING JAMB.
9. ATTACH INTERMEDIATE HORIZONTAL TO STRIKE JAMB AND GLAZING JAMB.
10. SNAP IN GLAZING HEAD INSERT

