

SolutionsII™

INSTALLATION INSTRUCTIONS

DRYWALL FRAMING CONSTRUCTION

Solutions II is a interior door frame and glazing system designed to fit over conventional drywall construction. The system is assembled into rough openings left in the drywall and attached to the wall. Solutions II fits over two common drywall throat sizes. They are 3-3/4" and 4-7/8" wall thicknesses.

Care should be taken by the drywall installer to keep the wall thickness as close to nominal as possible and never more than 1/8" thicker than nominal. Walls constructed greater than nominal may cause the trim not to sit flat against the drywall.

Note the C stud nearest the edge of the rough opening should be reversed so that the open end of the stud is towards the rough opening. This includes the head and sill if they cover drywall.

Before installing the frame, confirm the drywall is within tolerance in thickness and that the rough opening is the proper size and plumb.

DRYWALL CONSTRUCTION RECOMMENDED

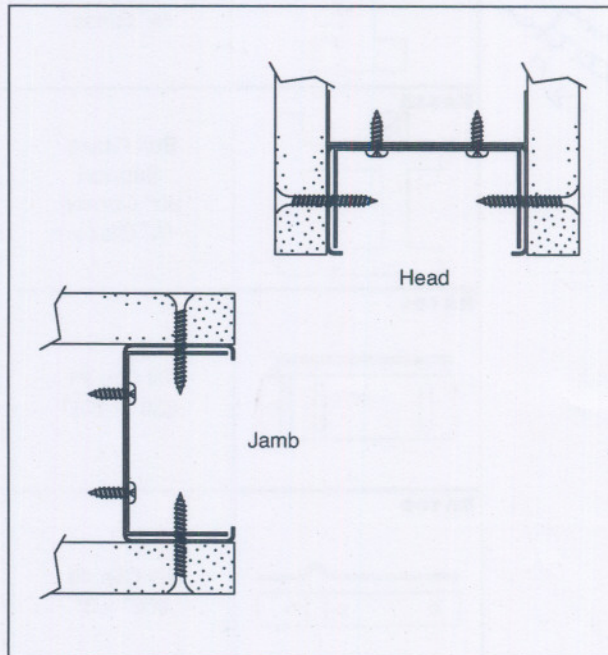
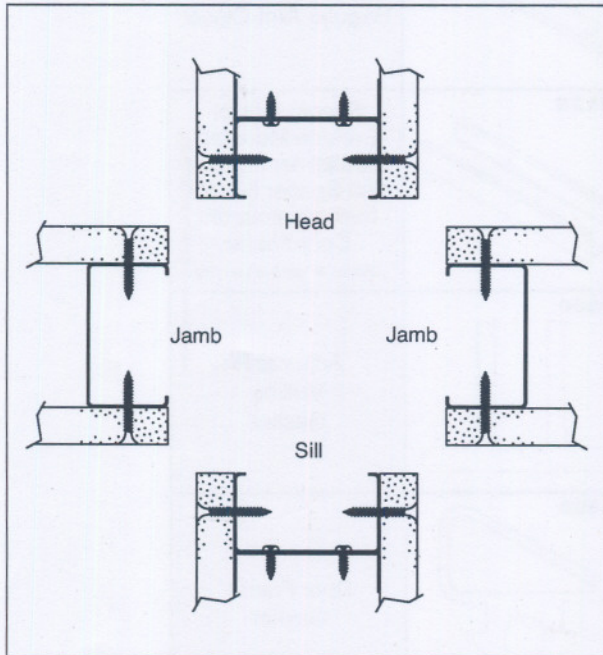

Shown with 6" Compressions Channel Segments. Use segments at areas where wall is wider than nominal drywall thickness dimensions. Wall will compress up to 1/4"