

---

**INSTALLATION INSTRUCTIONS**

---



---

**HOW TO FIGURE ROUGH OPENINGS**

---

**■ SINGLE OR DOUBLE DOOR FRAME WITHOUT SIDELIGHT**

- Rough Opening Width is equal to Door Opening Width plus 1-1/2"
- Rough Opening Height (less than Ceiling Height) is equal to Door Opening Height plus 3/4"

**■ SINGLE OR DOUBLE DOOR FRAME WITH SIDELIGHT ONE SIDE**

- Rough Opening Width is equal to Door Opening Width plus Day Light Opening Width of window(s) plus the width of the vertical intermediate(s) plus 1-1/2"
- Rough Opening Height (less than Ceiling Height) is equal to Door Opening Height plus 3/4" if sidelight is to the finished floor. If sidelight is over drywall at the sill, rough opening is DLO plus 1-1/2".

**■ SINGLE OR DOUBLE DOOR FRAME WITH SIDELIGHT ON BOTH SIDES**

- Rough Opening Width is equal to Door Opening Width plus Day Light Opening Width of the windows plus the width of the vertical intermediates plus 1-1/2"
- Rough Opening Height (less than Ceiling Height) is equal to Door Opening Height plus 3/4"

**■ SINGLE OR DOUBLE DOOR FRAME WITH TRANSOM LIGHT**

- Rough Opening Width is equal to Door Opening Width plus 1-1/2"
- Rough Opening Height (less than Ceiling Height) is equal to Door Opening Height plus Day Light Opening Height of Transom plus Door Frame Header Width plus 3/4"

**■ BORROWED LIGHT**

- Rough Opening Width is equal to Day Light Opening Width plus 1- 1/2"
- Rough Opening Height (less than Ceiling Height) is equal to Day Light Opening Height plus 1-1/2"

---

Rough opening tolerances are plus or minus 1/4"

All C studs nearest the edges of the rough opening should be reversed so that the open end of the stud is towards the rough opening.

The edge of the C studs should be flush with the edge of the drywall and care should be taken that the drywall edge is square and plumb.

All attachment screws should be embedded into the drywall. All screws attaching C studs and stud track should not cause the drywall to flare.

The drywall thickness should not exceed the nominal wall thickness. This includes head and sill conditions if covering drywall.

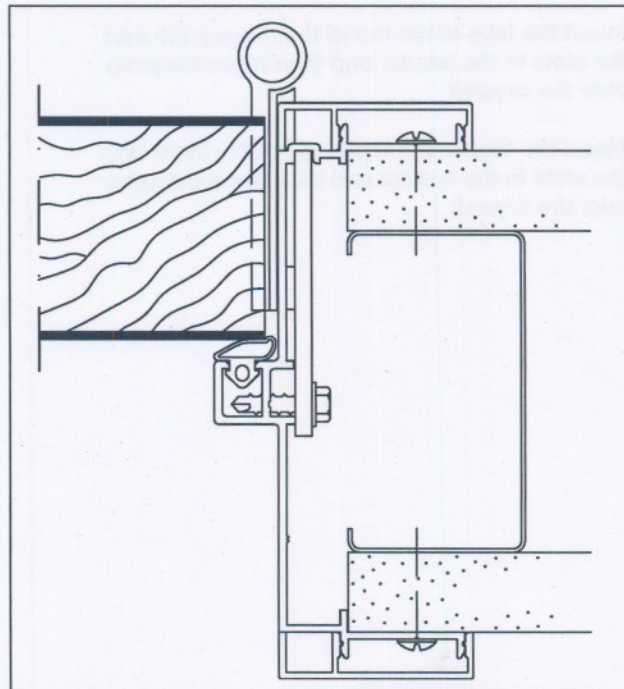

Cross Section Of Door Frame Jamb Showing Reversed C Stud And Coverage Of Frame Over Drywall