

Classic

5/8" DRYWALL CONSTRUCTION

Classic is an interior door frame and glazing system designed to fit over commercial drywall construction. The system is assembled into the rough opening left in the drywall and attached to the wall. Classic fits over three common drywall throat sizes. They are 2-1/4", 3-3/4" and 4-7/8" nominal wall thicknesses.

IMPORTANT:

WALL THICKNESS CANNOT EXCEED 1/16" THICKER THAN NOMINAL.

C-STUD INSET
4" AT DOOR
FRAME JAMBS

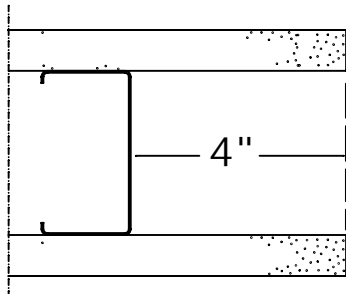

DOOR FRAME
JAMB *

C-STUD
REVERSED

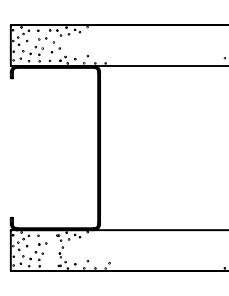

GLAZING
JAMB **

C-STUD
REVERSED



USE STANDARD
C-STUD AT HEAD

HEAD **



SILL **

FOR 1/2" DRYWALL APPLICATION:

* HOLD DOOR FRAME C STUD(S) BACK 10" AND FRAME MUST HAVE "SHIM STUDS".

** GLAZING JAMB, HEAD AND SILL C STUDS REQUIRE SHIM BETWEEN STUD AND DRYWALL FOR CORRECT FIT.